



MOTOR DATA SHEET

DS-APM-/12/23

GENERAL CHARACTERISTICS

Frame size		63
Type of construction		B14
Weight	[kg]	6.5
Moment of Inertia	[kgm ²]	0.0005
Degree of protection		IP69K
Direction of rotation		Both
Method of cooling		IC410
Duty		S1
Insulation class		F
Ambient temperature	[°C]	-15/+40
Dielectric Strength Test		2kV 1s

NAMEPLATE DATA and CONNECTION DIAGRAM

ALUMINUM PREMIUM MOTOR APM 63 B14

Ins.Cl.F Amb. max 40°C IC411 Duty S1

DE 6203.2Z NDE 6203.2Z Weight 6.5 Kg

Hz 50 Δ/Y 230/400V Hz 60 Δ/Y 277/480V

0.18 kW 0.8 / 0.5 A 0.25 HP 0.7 / 0.4 A

2890 min⁻¹ cosφ 0.81 3461 min⁻¹ PF. 78%

EFF(100%) 70.8 % NEMA DES.- CODE K

INVERTER DUTY

PWM SPEED RANGE 2.5:1: CT / 10:1 VT

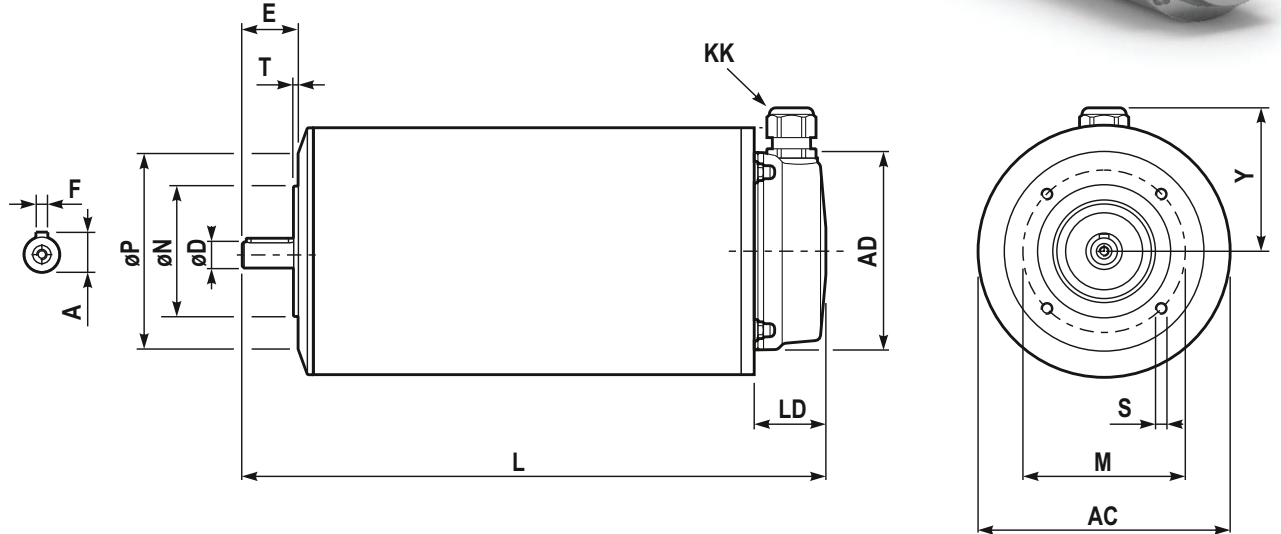

DIMENSIONS

AC	Ø133	LD	38.5
AD	Ø106	M	75
Y	78	ØN _{j6}	Ø60
L	264	ØP	Ø90
ØD _{j6}	Ø11	T	2.5
E	23	n x S	M5x13
F	4	KK ⁽¹⁾	M20x1.5
A	12.5		

BEARINGS

DE	6203.2Z
NDE	6203.2Z

SPECIAL EXECUTION AND ACCESSORIES

	code
-	
-	
-	
-	