



## MOTOR DATA SHEET DS\_APM\_06/23

### GENERAL CHARACTERISTICS

Frame size	71
Type of construction	B14
Weight [kg]	10.4
Moment of Inertia [kgm <sup>2</sup> ]	0.0021
Degree of protection	IP69K
Direction of rotation	Both
Method of cooling	IC410
Duty	S1
Insulation class	F
Ambient temperature [°C]	-15/+40
Dielectric Strength Test	2kV 1s

### NAMEPLATE DATA and CONNECTION DIAGRAM

## ALUMINUM PREMIUM MOTOR APM 71 B14

Ins.Cl.F Amb. max 40°C IC411 Duty S1  
 DE 6203.2Z NDE 6203.2Z Weight 10.4 Kg  
 Hz 50 Δ/Y 230/400V Hz 60 Δ/Y 264/460V  
 0.25 kW 1.1 / 0.7 A 03 HP 1.0 / 0.6 A  
 1444 min<sup>-1</sup> cosφ 0.75 1752 min<sup>-1</sup> PF. 69%  
 EFF(100%) 78.1 % NEMA DES.- CODE K  
 INVERTER DUTY  
 PWM SPEED RANGE 2.5:1: CT / 10:1 VT

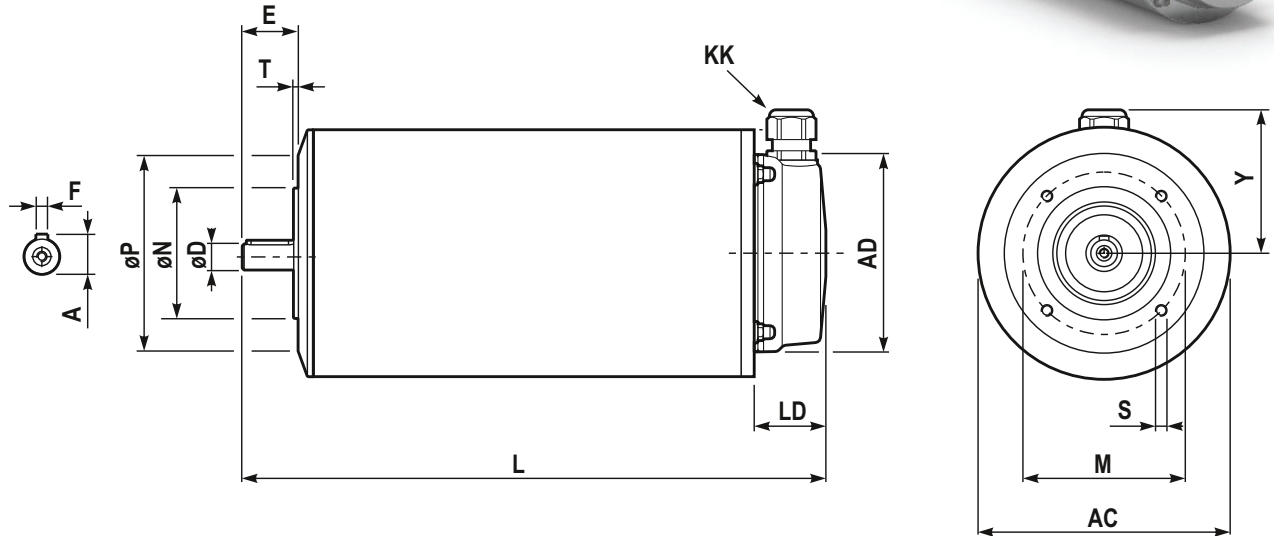

### DIMENSIONS

AC	Ø133	LD	38.5
AD	Ø106	M	85
Y	78	ØN <sub>j6</sub>	Ø70
L	311	ØP	Ø105
ØD <sub>j6</sub>	Ø14	T	2.5
E	30	n x S	M6x13
F	5	KK <sup>(1)</sup>	M20x1.5
A	16		

### BEARINGS

DE	6203.2Z
NDE	6203.2Z

### SPECIAL EXECUTION AND ACCESSORIES

	code
-	
-	
-	
-	