

## MOTOR DATA SHEET DS\_SPM\_01/24

### GENERAL CHARACTERISTICS

Frame size	80
Type of construction	B34
Weight [kg]	19.2
Moment of Inertia [kgm <sup>2</sup> ]	0.0032
Degree of protection	IP69K
Direction of rotation	Both
Method of cooling	IC410
Duty	S1
Insulation class	F
Ambient temperature [°C]	-15 / +40
Dielectric Strength Test	2kV 1s

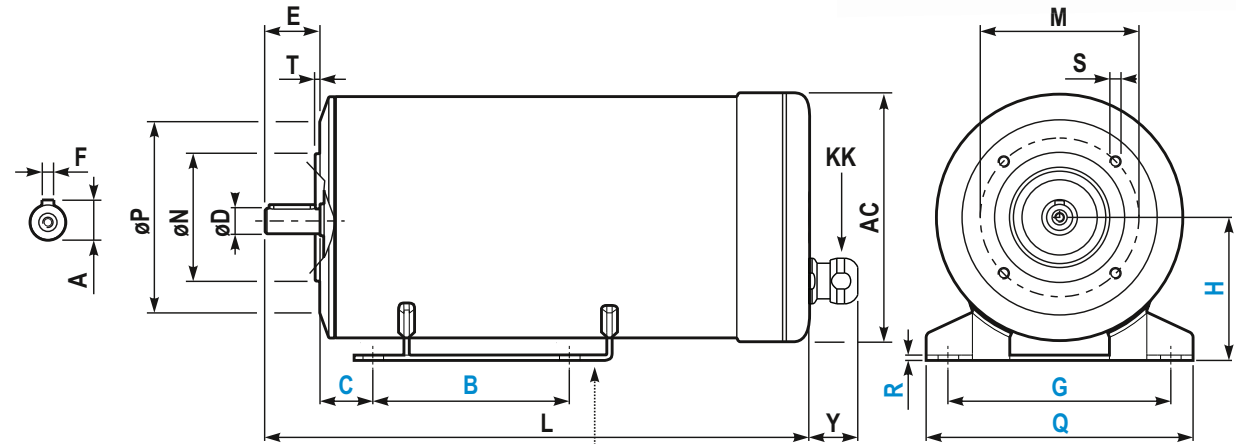

### NAMEPLATE DATA and CONNECTION DIAGRAM

#### PREMIUM MOTOR S.S.316L

#### SPM SPM80B4 IMB34

Ins.Cl.F Amb. max 40°C IC411 Duty S1 IP69K

DE 6205.2Z NDE 6205.2Z Weight 19.2 Kg

Hz 50 Δ/Y 230/400V Hz 60 Δ/Y 264/460V

0.75 kW 3.0 / 1.8 A 1 HP 2.7 / 1.6 A

1456 min<sup>-1</sup> cosφ 0.74 1768 min<sup>-1</sup> PF. 69 %

EFF(100%) % NEMA DES.- CODE K

INVERTER DUTY

PWM SPEED RANGE 2.5:1: CT / 10:1 VT

#### DIMENSIONS (mm)

AC	143
Y	27.5
L	340
∅D	19 j6 M6
E	40
F	6
A	21.5

M	∅ 100
∅N	∅ 80
∅P	∅ 120
T	3
n x S	4 M6 x 13
KK <sup>(1)</sup>	M20x1.5

#### FOOT DIMENSIONS (mm)

B	100
B1	-
C	50
G	125
H	80
U	10x14
Q	150
R	3

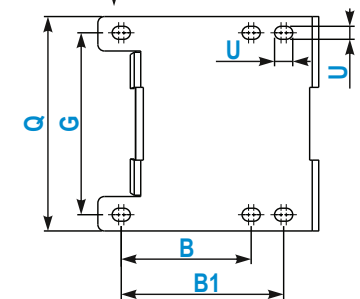

(1) Hygienic cable gland, EHEDG certified  
 Stainless steel, IP69K

### SPECIAL EXECUTION AND ACCESSORIES

	code
-	
-	
-	
-	

### BEARINGS

DE	6205.2Z
NDE	6205.2Z

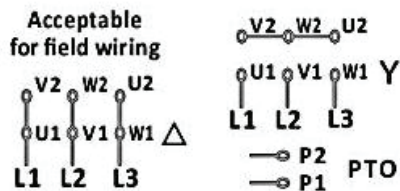

INVERTER DUTY  
 WASHDOWN  
 HYGIENIC  
 S.S. 316L  
 IP69K