



MOTOR DATA SHEET DS_APM_06/23

GENERAL CHARACTERISTICS

Frame size	90
Type of construction	B14
Weight [kg]	30.8
Moment of Inertia [kgm ²]	0.0107
Degree of protection	IP69K
Direction of rotation	Both
Method of cooling	IC410
Duty	S1
Insulation class	F
Ambient temperature [°C]	-15 / +40
Dielectric Strength Test	2kV 1s

NAMEPLATE DATA and CONNECTION DIAGRAM

ALUMINUM PREMIUM MOTOR APM 90 B14

Ins.Cl.F Amb. max 40°C IC411 Duty S1
 DE 6206.2Z NDE 6206.2Z Weight 30.8 Kg
 Hz 50 Δ/Y 230/400V Hz 60 Δ/Y 264/460V
 1.5 kW 5.7 / 3.5 A 2 HP 5.1 / 3.0 A
 1475 min⁻¹ cosφ 0.74 1785 min⁻¹ PF. 68%
 EFF(100%) 88.5 % NEMA DES.- CODE K
INVERTER DUTY
PWM SPEED RANGE 2.5:1: CT / 10:1 VT

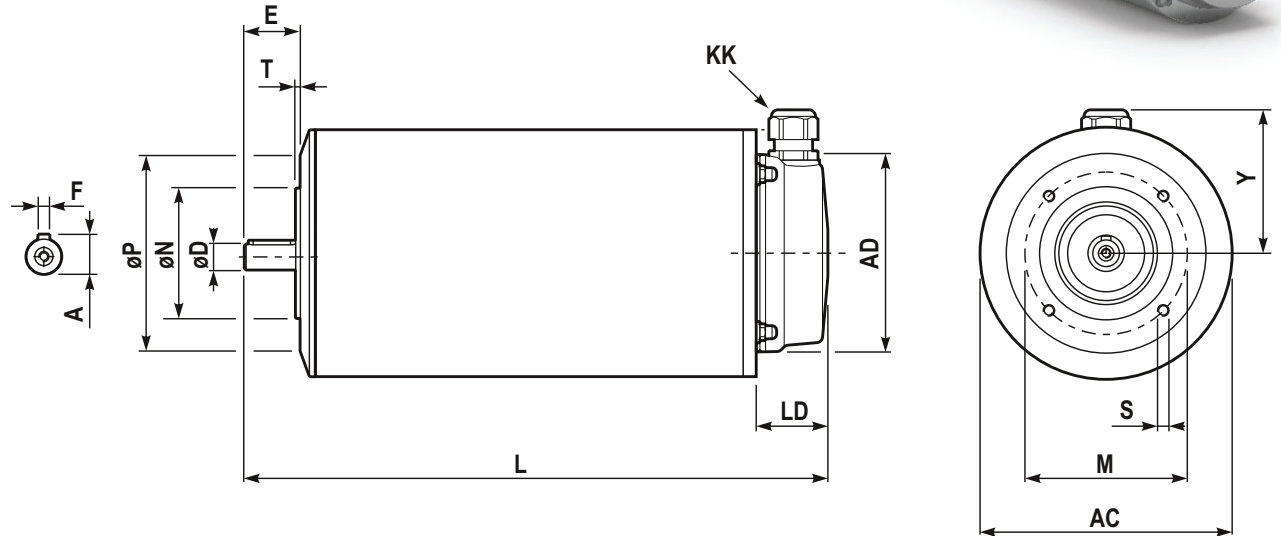

DIMENSIONS

AC	Ø181	LD	38.5
AD	Ø143	M	115
Y	97	ØN _{j6}	Ø95
L	386	ØP	Ø140
ØD _{j6}	Ø24	T	3
E	50	n x S	M8x16
F	8	KK ⁽¹⁾	M20x1.5
A	27		

BEARINGS

DE	6206.2Z
NDE	6206.2Z

SPECIAL EXECUTION AND ACCESSORIES

	code
-	
-	
-	
-	