

MOTOR DATA SHEET DS_SPM_05/22

GENERAL CHARACTERISTICS

Frame size	IEC72-1	90
Type of construction	IEC34-7	B14
Weight [kg]		35.4
Moment of Inertia [kgm ²]	Jo	0.0107
Degree of protection	IEC34-5	IP69K
Direction of rotation	Both	
Method of cooling	IEC34-6	IC410
Duty	IEC34-1	S1
Insulation class	IEC34-1	F
Ambient temperature [°C]	-15/+40	
Dielectric Strength Test	IEC34-1 2kV 1 s	

NAMEPLATE DATA and CONNECTION DIAGRAM

PREMIUM MOTOR S.S.316L 3~ SPM71A4 IMB14

Ins.Cl.F Amb. max 40°C IC410 Duty S1 IP69K
 DE 6206.2Z NDE 6206.2Z Weight 35.4 Kg

Hz 50 Δ/Y 230/400V Hz 60 Δ/Y 264/460V
 1.5 kW 5.7 / 3.5 A 2 HP 5.1 / 3.0 A
 1475 min⁻¹ cosφ 0.74 1785 min⁻¹ PF. 68 %

EFF(100%) 88.5 % NEMA DES.- CODE K

INVERTER DUTY

PWM SPEED RANGE 2.5:1: CT / 10:1 VT

Acceptable
for field wiring

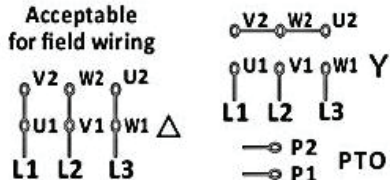

**INVERTER DUTY
 WASHDOWN
 HYGIENIC
 S.S. 316L
 IP69K**

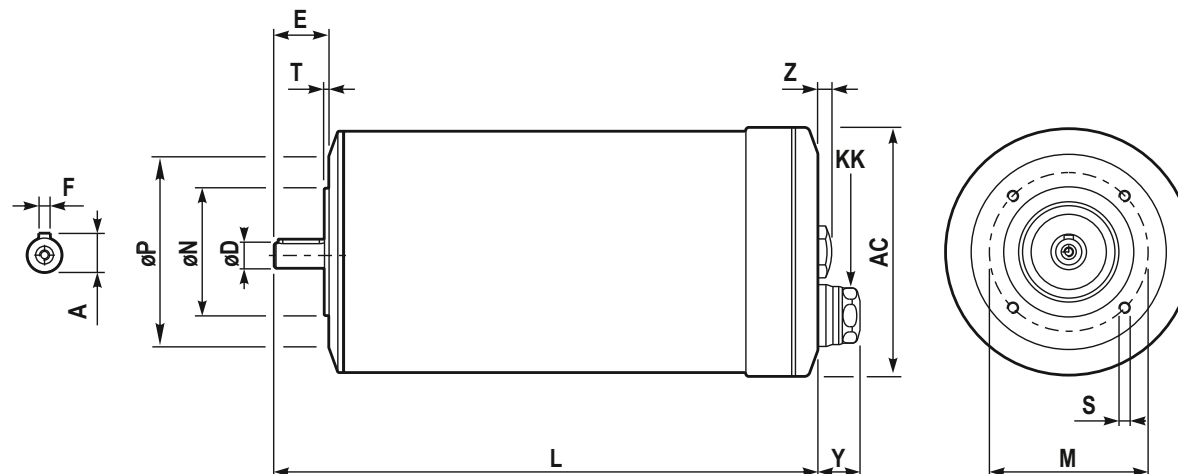

DIMENSIONS

AC	Ø 181	M	Ø 115
Y	22.5	ØN	Ø 95
L	372	ØP	Ø 140
ØD	24 j6 M8	T	3
E	50	n x S	4 M8 x 16
F	8	Z	7.4
A	27	KK ⁽¹⁾	M20x1.5 cable gland: clamping range Ø9-12 mm

BEARINGS

DE	6206.2Z
NDE	6206.2Z

(1) Hygienic cable gland, EHEDG certified
 Stainless steel, IP69K

SPECIAL EXECUTION AND ACCESSORIES

	code
-	
-	
-	