



MOTOR DATA SHEET DS-APM-/04/24

GENERAL CHARACTERISTICS

| | |
|---------------------------------------|---------|
| Frame size | 90 |
| Type of construction | B14 |
| Weight [kg] | 30.3 |
| Moment of Inertia [kgm ₂] | 0.0054 |
| Degree of protection | IP69K |
| Direction of rotation | Both |
| Method of cooling | IC410 |
| Duty | S1 |
| Insulation class | F |
| Ambient temperature [°C] | -15/+40 |
| Dielectric Strength Test | 2kV 1s |

NAMEPLATE DATA and CONNECTION DIAGRAM

ALUMINUM PREMIUM MOTOR APM 90 B14

Ins.Cl.F Amb. max 40°C IC411 Duty S1
 DE 6206.2Z NDE 6206.2Z Weight 30.3 Kg
 Hz 50 Δ/Y 230/400V Hz 60 Δ/Y 277/480V
 1.5 kW 5.2 / 3.0 A 2 HP 5.2 / 3.0 A
 2930 min⁻¹ cosφ 0.83 3545 min⁻¹ PF. 74%
EFF(100%) 86.54 % NEMA DES.- CODE K
INVERTER DUTY
PWM SPEED RANGE 2.5:1: CT / 10:1 VT

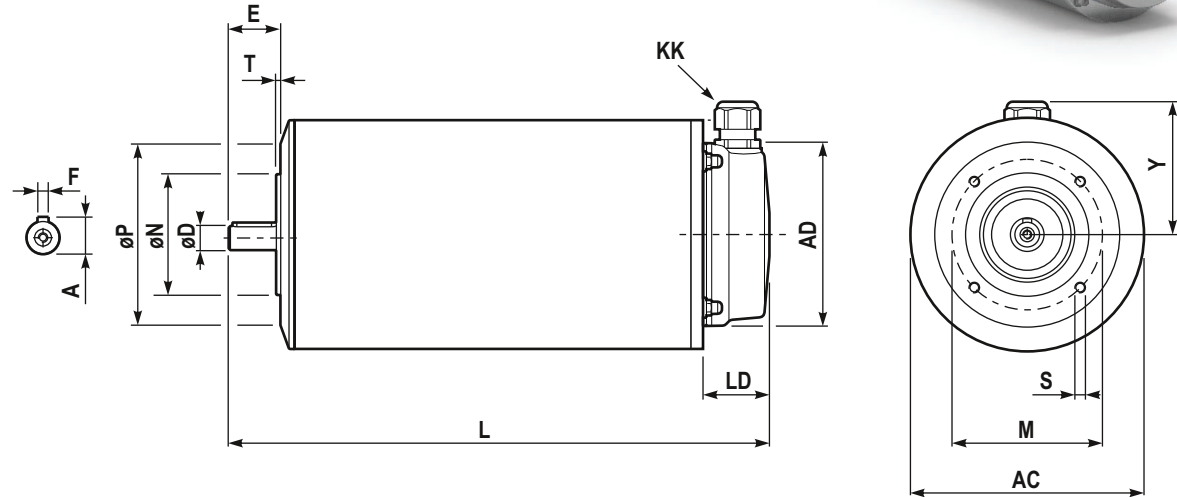

DIMENSIONS

| | | | |
|-------|------|--------|---------|
| AC | Ø183 | LD | 38.5 |
| AD | Ø143 | M | 115 |
| Y | 97 | ØN j6 | Ø95 |
| L | 386 | ØP | Ø140 |
| ØD j6 | Ø24 | T | 3 |
| E | 50 | n x S | M8x20 |
| F | 8 | KK (1) | M20x1.5 |
| A | 27 | | |

BEARINGS

| | |
|-----|---------|
| DE | 6206.2Z |
| NDE | 6206.2Z |

SPECIAL EXECUTION AND ACCESSORIES

| | |
|---|------|
| | code |
| - | |
| - | |
| - | |
| - | |