

Motor Designation
APM 1.1 kW 2p 80B
APMDKI2JTEN



MOTOR DATA SHEET DS-APM-/04/24

GENERAL CHARACTERISTICS

Frame size	80
Type of construction	B14
Weight [kg]	17.0
Moment of Inertia [kgm ²]	0.0017
Degree of protection	IP69K
Direction of rotation	Both
Method of cooling	IC410
Duty	S1
Insulation class	F
Ambient temperature [°C]	-15/+40
Dielectric Strength Test	2kV 1s

NAMEPLATE DATA and CONNECTION DIAGRAM

ALUMINUM PREMIUM MOTOR APM 80 B14

Ins.Cl.F Amb. max 40°C IC411 Duty S1
 DE 6205.2Z NDE 6205.2Z Weight 17.0 Kg
 Hz 50 Δ/Y 230/400V Hz 60 Δ/Y 277/480V
 1.1 kW 3.7 / 2.1 A 1.5 HP 3.5/ 2.0 A
 2910 min⁻¹ cosφ 0.86 3521 min⁻¹ PF. 80%
 EFF(100%) 86.4 % NEMA DES.- CODE K
 INVERTER DUTY
 PWM SPEED RANGE 2.5:1: CT / 10:1 VT

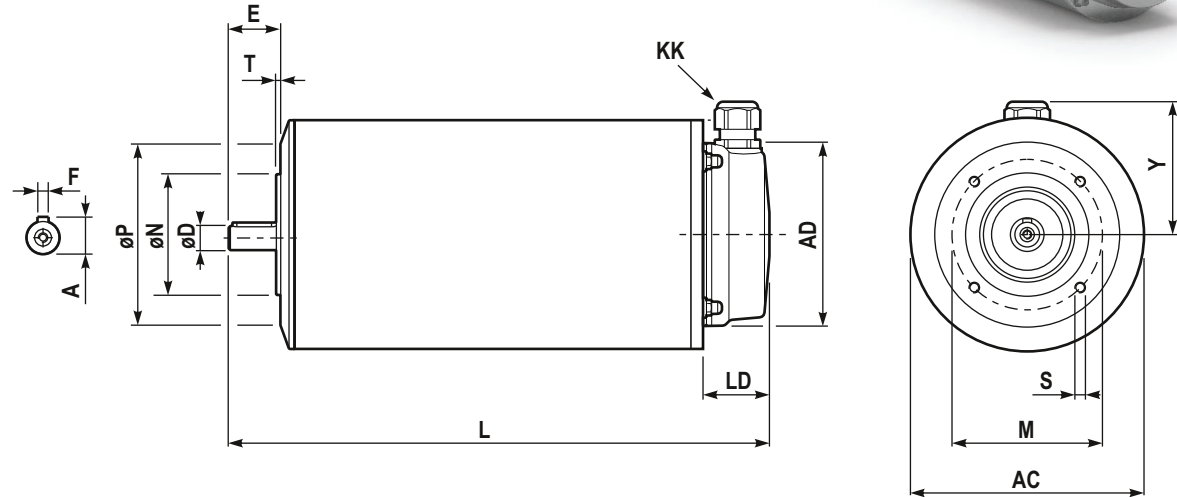

DIMENSIONS

AC	Ø143	LD	38.5
AD	Ø106	M	100
Y	78	ØN _{j6}	Ø80
L	350.5	ØP	Ø120
ØD _{j6}	Ø19	T	3
E	40	n x S	M6x15
F	6	KK ⁽¹⁾	M20x1.5
A	21.5		

BEARINGS

DE	6205.2Z
NDE	6205.2Z

SPECIAL EXECUTION AND ACCESSORIES

	code
-	
-	
-	
-	