



MOTOR DATA SHEET DS_SPM_09/23

GENERAL CHARACTERISTICS

Frame size		80
Type of construction		B14
Weight	[kg]	21.8
Moment of Inertia	[10 ⁻⁴ kgm ²]	0.0017
Degree of protection		IP69K
Direction of rotation		Both
Method of cooling		IC410
Duty		S1
Insulation class		F
Ambient temperature	[°C]	-15 / +40
Dielectric Strength Test	IEC34-1	2kV 1s

NAMEPLATE DATA and CONNECTION DIAGRAM

PREMIUM MOTOR S.S.316L

SPM 80B2 IMB14

Ins.Cl.F Amb. max 40°C IC411 Duty S1 IP69K

DE 6205.2Z NDE 6205.2Z Weight 21.8 Kg

Hz 50 Δ/Y 230/400V Hz 60 Δ/Y 264/460V

1.1 kW 3.7 / 2.1 A 1.5 HP 3.5 / 2.0 A

2910 min⁻¹ cosφ 0.86 3521 min⁻¹ PF. 80 %

EFF(100%) 86.4 % NEMA DES.- CODE K

INVERTER DUTY

PWM SPEED RANGE 2.5:1: CT / 10:1 VT

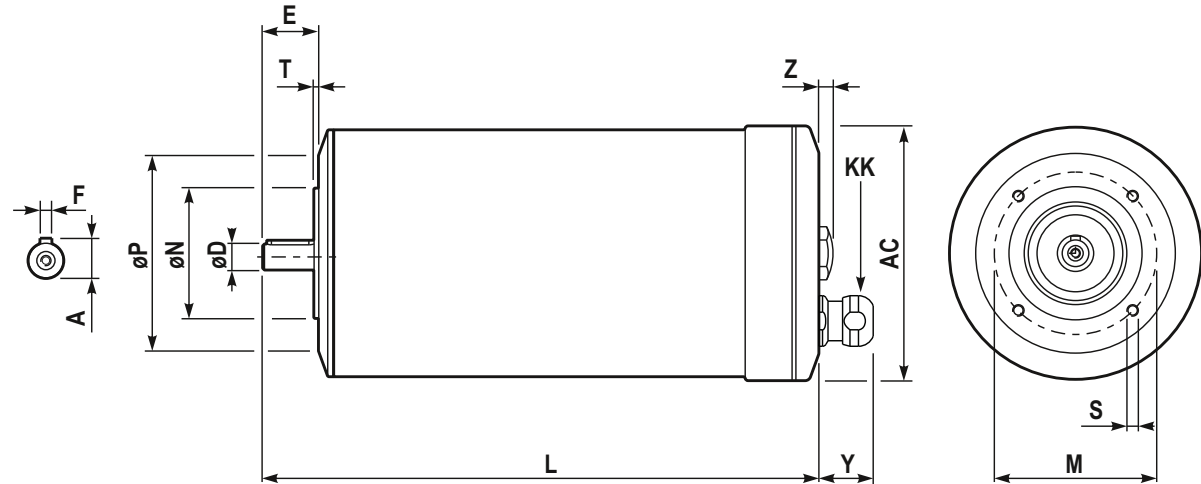

DIMENSIONS

AC	Ø143	M	Ø100
Y	22.5	ØN	Ø80 j6
L	340	ØP	Ø120
ØD	19 j6 M6	T	3
E	40	n x S	4 M6x13
F	6	Z	7.4
A	21.5	KK ⁽¹⁾	M20 x 1.5 cable gland clamping range Ø9-12 mm

BEARINGS

DE	6205.2Z
NDE	6205.2Z

(1) Hygienic cablegland, EHEDG certified
 Stainless steel, IP69K

SPECIAL EXECUTION AND ACCESSORIES

	code
-	
-	
-	

Acceptable for field wiring

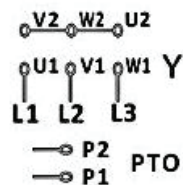
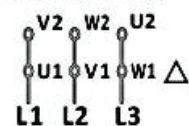

INVERTER DUTY
 WASHDOWN
 HYGIENIC
 S.S. 316L
 IP69K