



MOTOR DATA SHEET DS-APM-/06/23

GENERAL CHARACTERISTICS

| | | |
|--------------------------|---------------------|---------|
| Frame size | | 71 |
| Type of construction | | B14 |
| Weight | [kg] | 12.2 |
| Moment of Inertia | [kgm ²] | 0.0025 |
| Degree of protection | | IP69K |
| Direction of rotation | | Both |
| Method of cooling | | IC410 |
| Duty | | S1 |
| Insulation class | | F |
| Ambient temperature | [°C] | -15/+40 |
| Dielectric Strength Test | | 2kV 1s |

NAMEPLATE DATA and CONNECTION DIAGRAM

ALUMINUM PREMIUM MOTOR APM 71 B14

Ins.Cl.F Amb. max 40°C IC411 Duty S1
 DE 6203.2Z NDE 6203.2Z Weight 12.2 Kg

Hz 50 Δ/Y 230/400V Hz 60 Δ/Y 264/460V
 0.37 kW 1.6 / 1.0 A 0.5 HP 1.5 / 0.9 A
 1440 min⁻¹ cosφ 0.75 1748 min⁻¹ PF. 66%
 EFF(100%) 80.7 % NEMA DES.- CODE K
INVERTER DUTY
 PWM SPEED RANGE 2.5:1: CT / 10:1 VT

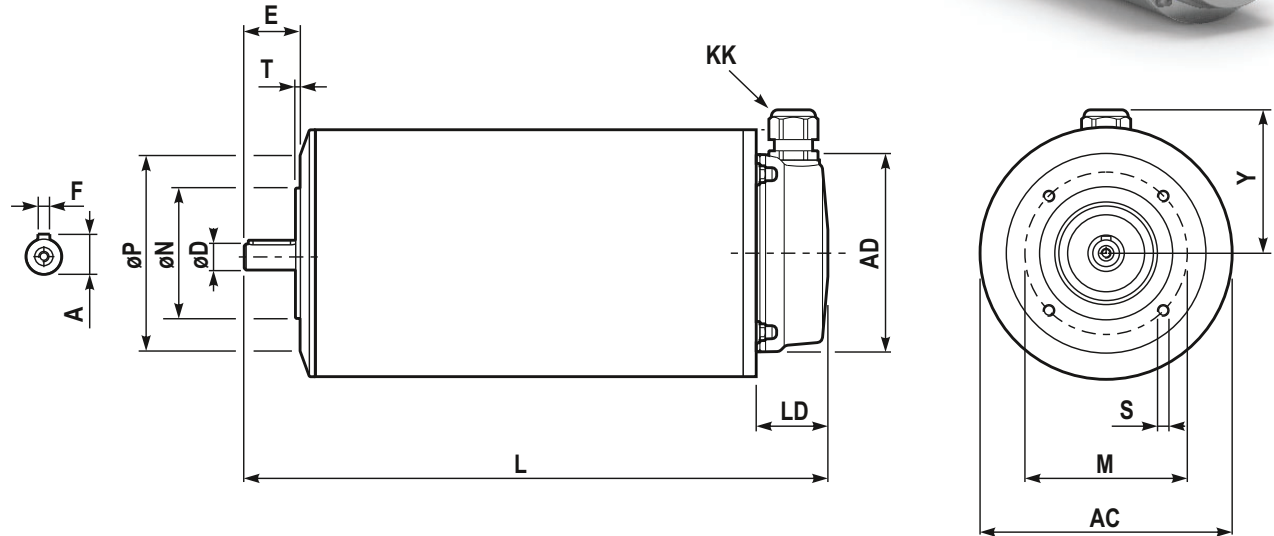

DIMENSIONS

| | | | |
|------------------|------|-------------------|---------|
| AC | Ø133 | LD | 38.5 |
| AD | Ø106 | M | 85 |
| Y | 78 | ØN _{j6} | Ø70 |
| L | 311 | ØP | Ø105 |
| ØD _{j6} | Ø14 | T | 2.5 |
| E | 30 | n x S | M6x13 |
| F | 5 | KK ⁽¹⁾ | M20x1.5 |
| A | 16 | | |

BEARINGS

| | |
|-----|---------|
| DE | 6203.2Z |
| NDE | 6203.2Z |

SPECIAL EXECUTION AND ACCESSORIES

| | code |
|---|------|
| - | |
| - | |
| - | |
| - | |