



MOTOR DATA SHEET DS_APM_06/23

GENERAL CHARACTERISTICS

| | |
|---------------------------------------|-----------|
| Frame size | 63 |
| Type of construction | B14 |
| Weight [kg] | 8.7 |
| Moment of Inertia [kgm ²] | 0.0016 |
| Degree of protection | IP69K |
| Direction of rotation | Both |
| Method of cooling | IC410 |
| Duty | S1 |
| Insulation class | F |
| Ambient temperature [°C] | -15 / +40 |
| Dielectric Strength Test | 2kV 1s |

NAMEPLATE DATA and CONNECTION DIAGRAM

ALUMINUM PREMIUM MOTOR APM 63 B14

Ins.Cl.F Amb. max 40°C IC411 Duty S1

DE 6203.2Z NDE 6203.2Z Weight 8.7 Kg

Hz 50 Δ/Y 230/400V Hz 60 Δ/Y 264/460V

0.18 kW 0.8 / 0.5 A 0.25 HP 0.8 / 0.5 A

1446 min⁻¹ cosφ 0.76 1752 min⁻¹ PF. 71%

EFF(100%) 77.3 % NEMA DES.- CODE K

INVERTER DUTY

PWM SPEED RANGE 2.5:1: CT / 10:1 VT

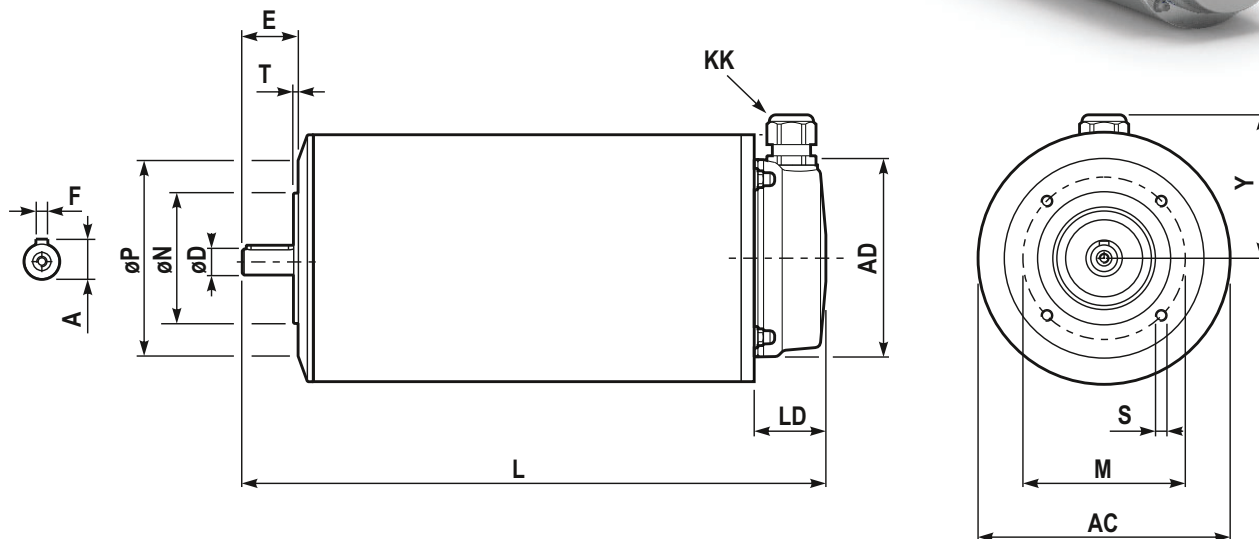

DIMENSIONS

| | | | |
|------------------|------|-------------------|---------|
| AC | Ø133 | LD | 38.5 |
| AD | Ø106 | M | 75 |
| Y | 78 | ØN _{j6} | Ø60 |
| L | 264 | ØP | Ø90 |
| ØD _{j6} | Ø11 | T | 2.5 |
| E | 23 | n x S | M5x13 |
| F | 4 | KK ⁽¹⁾ | M20x1.5 |
| A | 12.5 | | |

BEARINGS

| | |
|-----|---------|
| DE | 6203.2Z |
| NDE | 6203.2Z |

SPECIAL EXECUTION AND ACCESSORIES

| | code |
|---|------|
| - | |
| - | |
| - | |
| - | |