



## MOTOR DATA SHEET DS\_APM\_06/23

### GENERAL CHARACTERISTICS

Frame size		80
Type of construction		B14
Weight	[kg]	13.4
Moment of Inertia	[kgm <sup>2</sup> ]	0.0026
Degree of protection		IP69K
Direction of rotation		Both
Method of cooling		IC410
Duty		S1
Insulation class		F
Ambient temperature	[°C]	-15 / +40
Dielectric Strength Test		2kV 1s

### NAMEPLATE DATA and CONNECTION DIAGRAM

## ALUMINUM PREMIUM MOTOR APM 80 B14

Ins.Cl.F Amb. max 40°C IC411 Duty S1  
 DE 6205.2Z NDE 6205.2Z Weight 13.4 Kg

Hz 50 Δ/Y 230/400V Hz 60 Δ/Y 264/460V  
 0.55 kW 2.3 / 1.4 A 0.75 HP 2.1 / 1.2 A  
 1448 min<sup>-1</sup> cosφ 0.73 1755 min<sup>-1</sup> PF. 66%  
**EFF(100%) 82.2 % NEMA DES.- CODE K**  
**INVERTER DUTY**  
**PWM SPEED RANGE 2.5:1: CT / 10:1 VT**

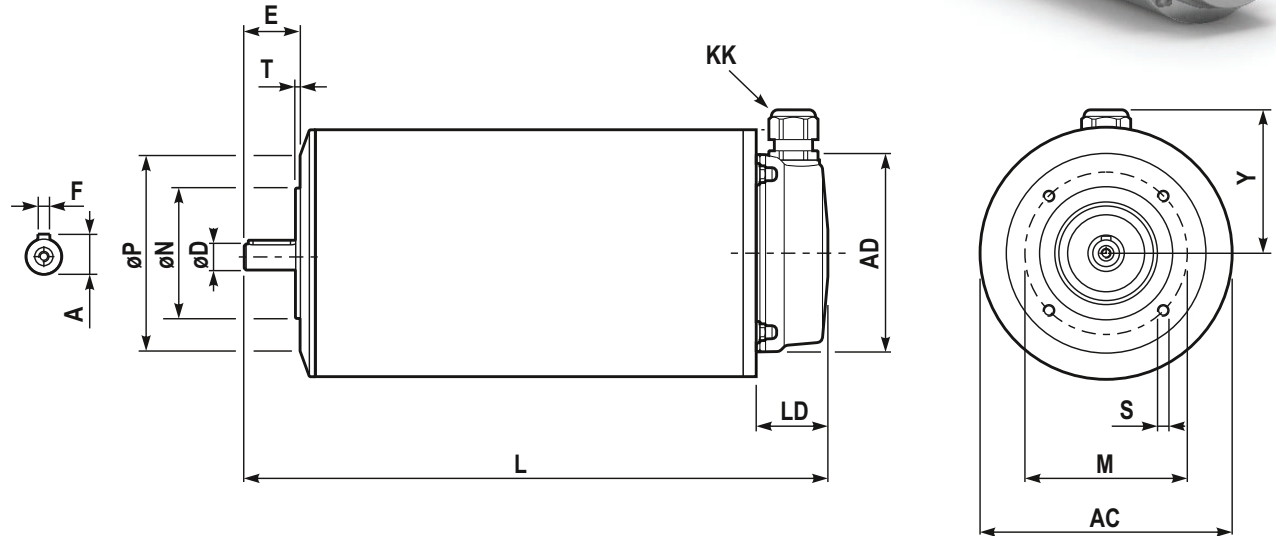

### DIMENSIONS

AC	Ø143	LD	38.5
AD	Ø106	M	100
Y	78	ØN <sub>j6</sub>	Ø80
L	350.5	ØP	Ø120
ØD <sub>j6</sub>	Ø19	T	3
E	40	n x S	M6x13
F	6	KK <sup>(1)</sup>	M20x1.5
A	21.5		

### BEARINGS

DE	6205.2Z
NDE	6205.2Z

### SPECIAL EXECUTION AND ACCESSORIES

	code
-	
-	
-	
-	