

## MOTOR DATA SHEET DS\_SPM\_04/22

### GENERAL CHARACTERISTICS

Frame size	IEC72-1	71
Type of construction	IEC34-7	B14
Weight [kg]		13.2
Moment of Inertia [kgm <sup>2</sup> ]	Jo	0.0025
Degree of protection	IEC34-5	IP69K
Direction of rotation	Both	
Method of cooling	IEC34-6	IC410
Duty	IEC34-1	S1
Insulation class	IEC34-1	F
Ambient temperature [°C]	-15/+40	
Dielectric Strength Test	IEC34-1 2kV 1 s	

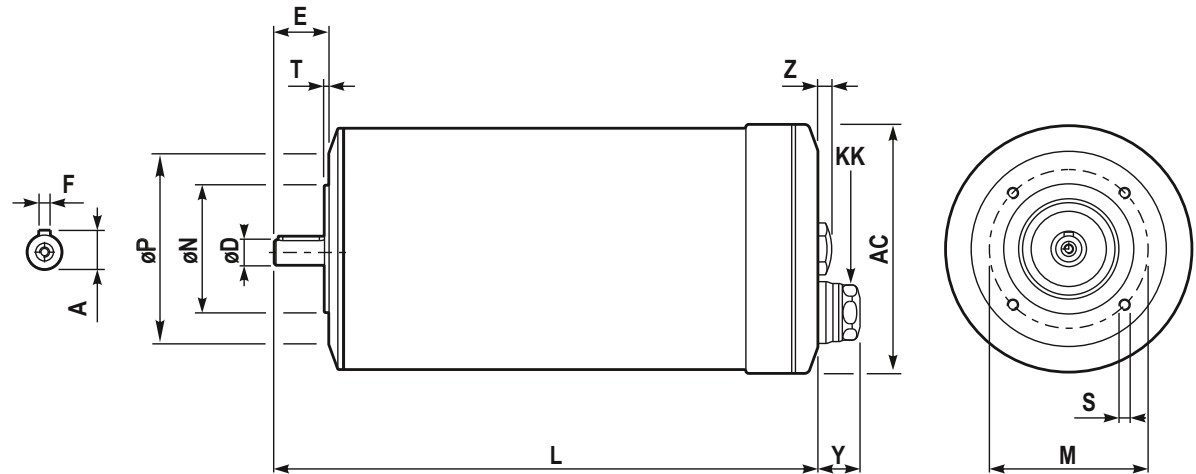

### NAMEPLATE DATA and CONNECTION DIAGRAM

### PREMIUM MOTOR S.S.316L 3~ SPM71B4 IMB14

Ins.Cl.F Amb. max 40°C IC410 Duty S1 IP69K  
 DE 6203.2Z NDE 6203.2Z Weight 13.2 Kg

Hz 50 Δ/Y 230/400V Hz 60 Δ/Y 264/460V

0.37 kW 1.6 / 1.0 A 0.5 HP 1.5 / 0.9 A

1440 min<sup>-1</sup> cosφ 0.71 1748 min<sup>-1</sup> PF. 66 %

EFF(100%) 80.7 % NEMA DES.- CODE K

INVERTER DUTY

PWM SPEED RANGE 2.5:1: CT / 10:1 VT

Acceptable  
for field wiring

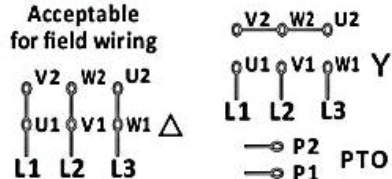

INVERTER DUTY  
 WASHDOWN  
 HYGIENIC  
 S.S. 316L  
 IP69K

### DIMENSIONS

AC	Ø 133	M	Ø 85
Y	22.5	ØN	Ø 70
L	294.5	ØP	Ø 105
ØD	14 j6 M5	T	2.5
E	30	n x S	4 M6 x 13
F	5	Z	7.4
A	16	KK <sup>(1)</sup>	M20x1.5 cable gland: clamping range Ø9-12 mm

### BEARINGS

DE	6203.2Z
NDE	6203.2Z

(1) Hygienic cablegland, EHEDG certified  
 Stainless steel, IP69K

### SPECIAL EXECUTION AND ACCESSORIES

	code
-	
-	
-	