

Trapezoidal nut type FMT - Flanged bronze

Material: EN 1982 Cu Sn12-C – CC483K

Tin bronze nut especially suitable for continuous movement with good wear resistance. Good lubrication is recommended.

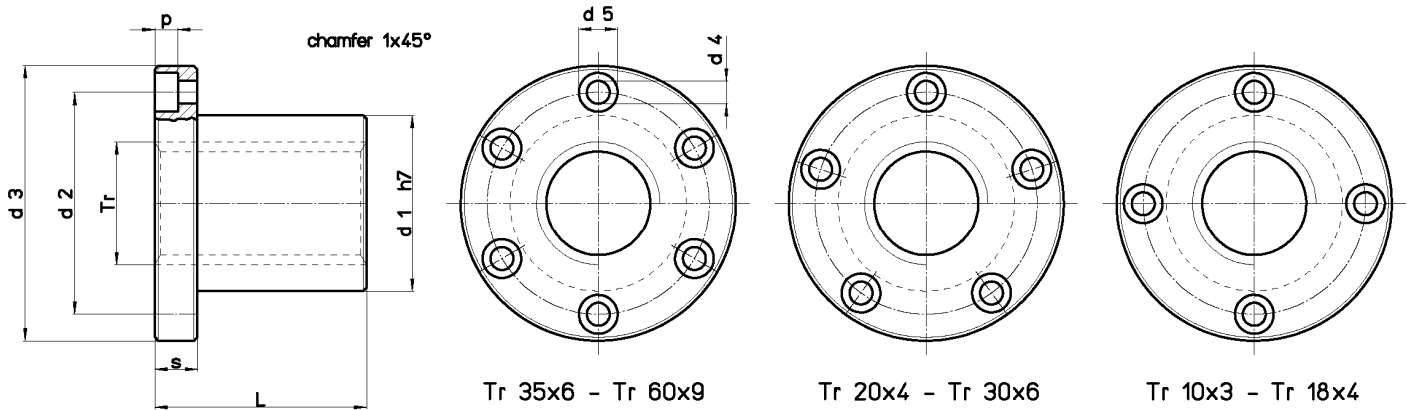

PAY ATTENTION TO THE NUMBER OF FASTENING SCREW HOLES SPECIFIED IN THE TABLE

| Nut Stock no. RIGHT | Nut Stock no. LEFT | Diameter x lead | Thread starts | d1 mm | d2 mm | d3 mm | d4 mm | d5 mm | p mm | L mm | s mm | no. screw holes | Fastening screws (class 8.8) | Wt. kg/each | At mm ² (1) |
|----------------------------|---------------------------|----------------------|---------------|-------|-------|-------|-------|-------|------|------|------|-----------------|------------------------------|-------------|------------------------|
| FMT 10 A R | -- | Tr 10x3 | 1 | 18 | 26 | 37 | 4.5 | 7.5 | 4.2 | 22 | 8 | 4 | M4 | 0.088 | 294 |
| FMT 12 A R | FMT 12 A L | Tr 12x3 | 1 | 18 | 26 | 37 | 4.5 | 7.5 | 4.2 | 22 | 8 | 4 | M4 | 0.082 | 362 |
| FMT 12 B R | -- | Tr 12x6 (P3) | 2 | 18 | 26 | 37 | 4.5 | 7.5 | 4.2 | 22 | 8 | 4 | M4 | 0.082 | 362 |
| FMT 14 A R | FMT 14 A L | Tr 14x4 | 1 | 20 | 30 | 42 | 5.5 | 9,5 | 5.2 | 25 | 10 | 4 | M5 | 0.123 | 470 |
| FMT 16 A R | FMT 16 A L | Tr 16x4 | 1 | 22 | 32 | 45 | 5.5 | 9,5 | 5.2 | 30 | 10 | 4 | M5 | 0.149 | 660 |
| FMT 16 B R | -- | Tr 16x8 (P4) | 2 | 22 | 32 | 45 | 5.5 | 9,5 | 5.2 | 30 | 10 | 4 | M5 | 0.149 | 660 |
| FMT 18 A R | FMT 18 A L | Tr 18x4 | 1 | 25 | 35 | 48 | 5.5 | 9,5 | 5.2 | 35 | 10 | 4 | M5 | 0.188 | 880 |
| FMT 20 A R | FMT 20 A L | Tr 20x4 | 1 | 30 | 40 | 52 | 5.5 | 9,5 | 5.2 | 40 | 10 | 5 | M5 | 0.263 | 1130 |
| FMT 20 B R | -- | Tr 20x8 (P4) | 2 | 30 | 40 | 52 | 5.5 | 9,5 | 5.2 | 40 | 10 | 5 | M5 | 0.263 | 1130 |
| FMT 22 A R | FMT 22 A L | Tr 22x5 | 1 | 30 | 40 | 52 | 5.5 | 9,5 | 5.2 | 40 | 10 | 5 | M5 | 0.244 | 1225 |
| FMT 25 A R | FMT 25 A L | Tr 25x5 | 1 | 35 | 48 | 62 | 6.5 | 11 | 6.5 | 45 | 12 | 5 | M6 | 0.386 | 1590 |
| FMT 25 B R | -- | Tr 25x10 (P5) | 2 | 35 | 48 | 62 | 6.5 | 11 | 6.5 | 45 | 12 | 5 | M6 | 0.386 | 1590 |
| FMT 28 A R | FMT 28 A L | Tr 28x5 | 1 | 40 | 53 | 68 | 6.5 | 11 | 6.5 | 50 | 12 | 5 | M6 | 0.538 | 2000 |
| FMT 30 A R | FMT 30 A L | Tr 30x6 | 1 | 40 | 53 | 68 | 6.5 | 11 | 6.5 | 50 | 12 | 5 | M6 | 0.504 | 2120 |
| FMT 30 B R | -- | Tr 30x12 (P6) | 2 | 40 | 53 | 68 | 6.5 | 11 | 6.5 | 50 | 12 | 5 | M6 | 0.504 | 2120 |
| FMT 35 A R | FMT 35 A L | Tr 35x6 | 1 | 50 | 63 | 78 | 6.5 | 11 | 6.5 | 60 | 12 | 6 | M6 | 0.872 | 3015 |
| FMT 36 A R | FMT 36 A L | Tr 36x6 | 1 | 50 | 63 | 78 | 6.5 | 11 | 6.5 | 60 | 12 | 6 | M6 | 0.845 | 3110 |
| FMT 40 A R | FMT 40 A L | Tr 40x7 | 1 | 55 | 68 | 84 | 6.5 | 11 | 6.5 | 65 | 12 | 6 | M6 | 1.059 | 3727 |
| FMT 40 B R | -- | Tr 40x14 (P7) | 2 | 55 | 68 | 84 | 6.5 | 11 | 6.5 | 65 | 12 | 6 | M6 | 1.059 | 3727 |
| FMT 45 A R | FMT 45 A L | Tr 45x8 | 1 | 55 | 72 | 90 | 8.5 | 14 | 8.5 | 65 | 15 | 6 | M8 | 0.999 | 4186 |
| FMT 50 A R | FMT 50 A L | Tr 50x8 | 1 | 65 | 80 | 100 | 8.5 | 14 | 8.5 | 80 | 15 | 6 | M8 | 1.679 | 5780 |
| FMT 55 A R | -- | Tr 55x9 | 1 | 70 | 95 | 120 | 10.5 | 17 | 10.5 | 80 | 18 | 6 | M10 | 2.325 | 6345 |
| FMT 60 A R | FMT 60 A L | Tr 60x9 | 1 | 75 | 95 | 120 | 10.5 | 17 | 10.5 | 100 | 18 | 6 | M10 | 2.701 | 8718 |

(1) Total bearing surface between screw and nut teeth on plane perpendicular to axis.