

MOTOR DATA SHEET DS_SPM_05/24

GENERAL CHARACTERISTICS

Frame size		90
Type of construction		B5
Weight	[kg]	34.5
Moment of Inertia	[kgm ²]	0.056
Degree of protection		IP69K
Direction of rotation		Both
Method of cooling		IC410
Duty		S1
Insulation class		F
Ambient temperature	[°C]	-15 / +40
Dielectric Strength Test		2kV 1s

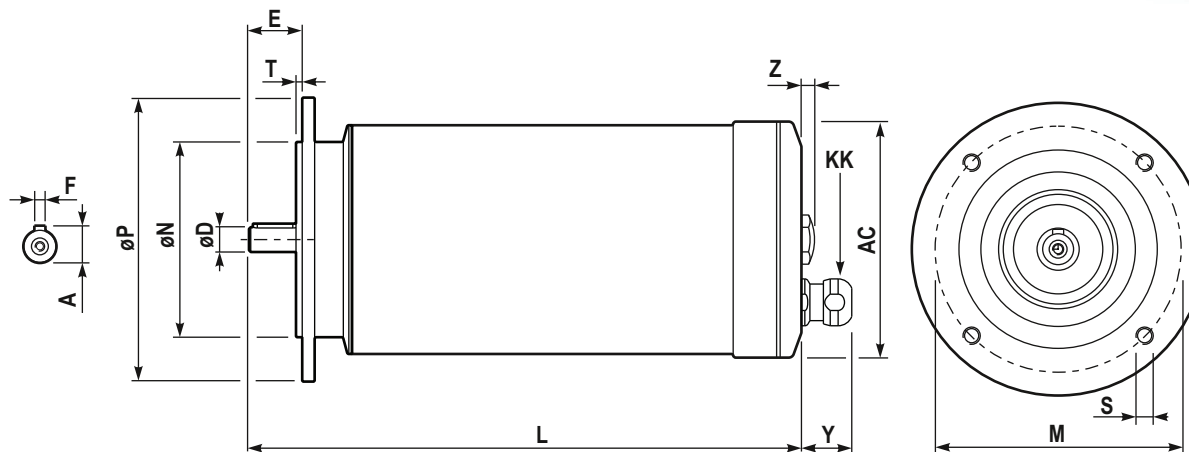

NAMEPLATE DATA and CONNECTION DIAGRAM

PREMIUM MOTOR S.S.316L SPM 90L2 IMB5

Ins.Cl.F Amb. max 40°C IC411 Duty S1 IP69K
 DE 6206.2Z NDE 6206.2Z Weight 34.5 Kg

Hz 50 Δ/Y 230/400V Hz 60 Δ/Y 264/460V
 2.2 kW 7.3 / 4.2 A 3 HP 6.6 / 3.9 A
 2920 min⁻¹ cosφ 0.82 3520 min⁻¹ PF. 82 %
 EFF(100%) 86 % NEMA DES.- CODE K

INVERTER DUTY

PWM SPEED RANGE 2.5:1: CT / 10:1 VT

Acceptable for field wiring

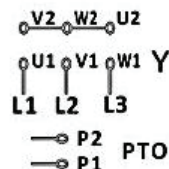
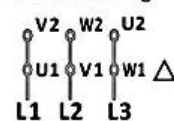

INVERTER DUTY
 WASHDOWN
 HYGIENIC
 S.S. 316L
 IP69K

DIMENSIONS

AC	181	M	Ø165
Y	27.5	ØN	Ø130
L	402	ØP	Ø200
ØD	24 j6 M8	T	3.5
E	50	n x S	4 x Ø12
F	8	Z	7.4
A	27	KK ⁽¹⁾	M20x1.5 cable gland clamping range Ø9-12mm

BEARINGS

DE	6206.2Z
NDE	6206.2Z

(1) Hygienic cable gland, EHEDG certified Stainless steel, IP69K

SPECIAL EXECUTION AND ACCESSORIES

	code
-	
-	
-	
-	