



MOTOR DATA SHEET DS_SPM_04/24

GENERAL CHARACTERISTICS

Frame size		90
Type of construction		B14
Weight	[kg]	33.5
Moment of Inertia	[kgm ²]	0.0056
Degree of protection		IP69K
Direction of rotation		Both
Method of cooling		IC410
Duty		S1
Insulation class		F
Ambient temperature	[°C]	-15 / +40
Dielectric Strength Test	IEC34-1	2kV 1s

NAMEPLATE DATA and CONNECTION DIAGRAM

PREMIUM MOTOR S.S.316L

SPM 90L2 IMB14

Ins.Cl.F Amb. max 40°C IC411 Duty S1 IP69K

DE 6206.2Z NDE 6206.2Z Weight 33.5 Kg

Hz 50 Δ/Y 230/400V Hz 60 Δ/Y 264/460V

2.2 kW 7.3 / 4.2 A 3 HP 6.6 / 3.9 A

2920 min⁻¹ cosφ 0.82 3520 min⁻¹ PF. 82 %

EFF(100%) 86.0 % NEMA DES.- CODE K

INVERTER DUTY

PWM SPEED RANGE 2.5:1: CT / 10:1 VT

Acceptable for field wiring

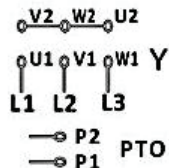
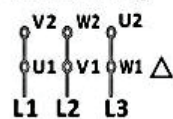

INVERTER DUTY
 WASHDOWN
 HYGIENIC
 S.S. 316L
 IP69K

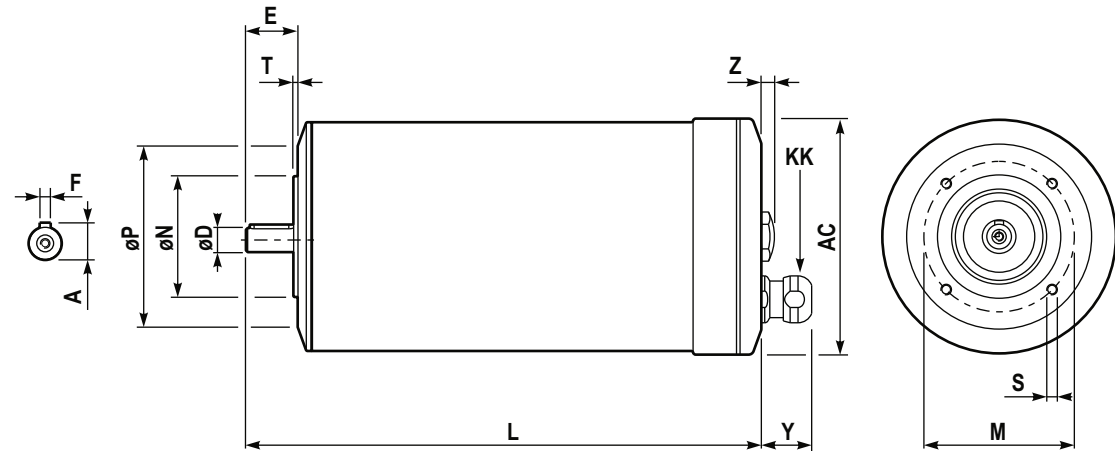

DIMENSIONS

AC	Ø181	M	Ø115
Y	27.5	ØN	Ø95 j6
L	372	ØP	Ø140
ØD	24 j6 M8	T	3
E	50	n x S	4 M8x16
F	8	Z	7.4
A	27	KK (1)	M20 x 1.5 cable gland clamping range Ø9-12 mm

BEARINGS

DE	6206.2Z
NDE	6206.2Z

(1) Hygienic cablegland, EHEDG certified Stainless steel, IP69K

SPECIAL EXECUTION AND ACCESSORIES

	code
-	
-	
-	
-	